

Dear NSB Bank Customers,

Online Banking Updates for Security

In order to ensure your online banking is more secure our online banking provider has implemented the use of Transport Layer Security (TLS) v1.2 protocol. This will take effect as of Monday, May 14th. Due to the enhanced security within Transport Layer Security (TLS) v1.2 you will no longer be able to use out-of-date browsers. Please see below for list of browsers and their TLS 1.2 compatibility:

Browsers and Operating Systems	TLS 1.2 Compatibility Notes
Microsoft Edge	Compatible by default
Microsoft IE Desktop and mobile version 11	Compatible by default
Microsoft IE Desktop versions 9 and 10	Capable when run in Windows 7 or newer, but not enabled by default
Firefox 27 and higher	Compatible by default
Google Chrome 38 and higher	Compatible by default

Oracle Java version 1.7 and higher	Compatible by default
Mobile Safari versions 5 and higher	Compatible by default
Microsoft Windows Server 2008 R2 and higher	Compatible by default
Microsoft Windows Server 2008 and below	Not compatible with TLS 1.2
Microsoft Windows 7, 8.0, 8.1 and 10	Compatible by default
Microsoft XP/Vista and below	Not compatible with TLS 1.2

How to Enable Transport Layer Security (TLS) 1.2 on Internet Explorer

1. From your internet browser, select **Tools**, then **Internet Options**.
2. Click the **Advanced Tab** and scroll down to Security section.

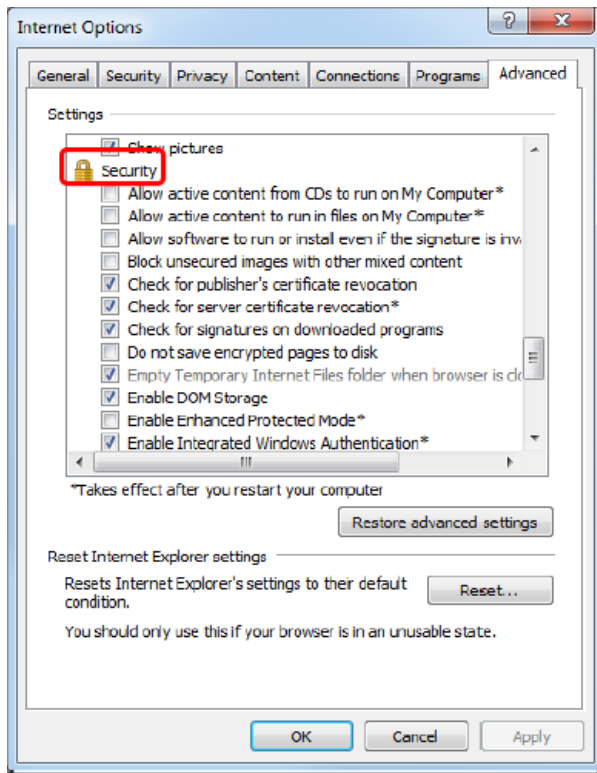

a.

3. Ensure TLS 1.2 is checked, if not check **TLS 1.2** and select, **Apply**, **OK**.

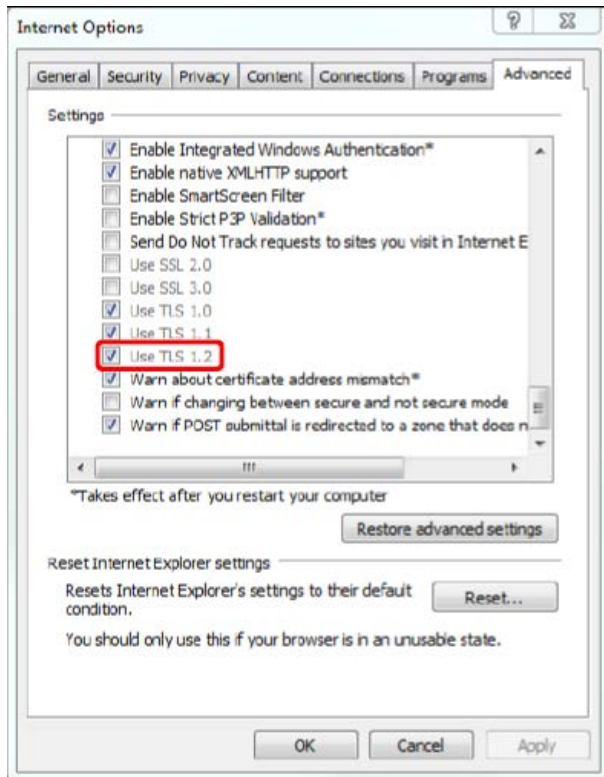

a.

*****Do not uncheck any of the other TLS options. Just make sure Use TLS 1.2 is checked.

How to Enable Transport Layer Security (TLS) 1.2 on Google Chrome.

1. Open Google Chrome.
2. Click ALT F and select
3. Scroll down and click advanced
4. Scroll down and find the System section and click to Open Proxy settings
5. Now click on the Advanced Tab
6. Scroll down to the Security Section until you find Use TLS 1.0, 1.1 and 1.2. Make sure there is a checkmark in the Use TLS 1.2 box.
7. Click Ok if you made a change.

*****Do not uncheck any of the other TLS options. Just make sure Use TLS 1.2 is checked.